



Easyway Automation Co.,Ltd

ER03 Auto parts loading system for lathe





ER03 Auto parts loading system for lathe

Characteristics

- Good working efficiencies and Cleaning factory. The quickest part change time is 7 seconds (Include one time part clamping, unclamping and air blower standard processes); Door open and close time be saved; Oil mist would not spread everywhere.
- Smaller Floor area
- Low cost maintenance • We don't need to do lubrication for speed reducer frequently.

Easy conversation interface operation

- Easy learning with English language
- Easy maintenance with acting message
- 5.7" Black & white LCD display (Color 6.5" TFT is option)
- Key protection function.
- The main operation use hardware buttons, giving us more safety and reliable operation environment.

EA03 Jaws set (SMC air chuck), Soft jaws & fixture for jaws repairing

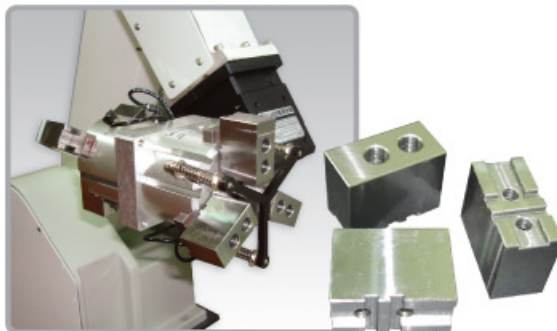

Disk Feeder



Bowl Feeder

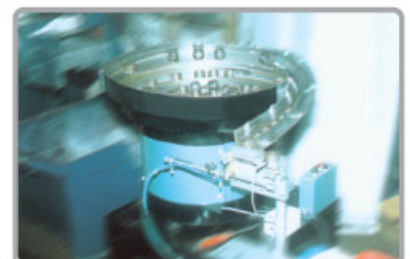

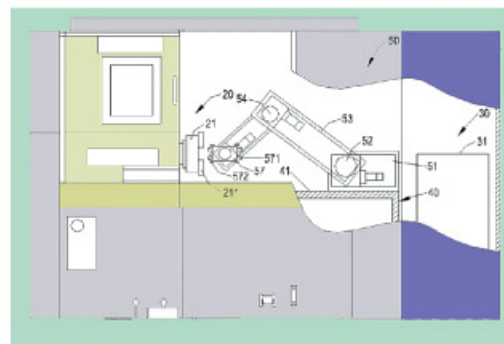
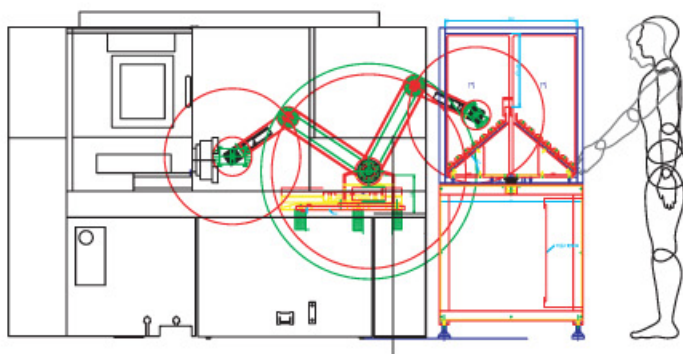
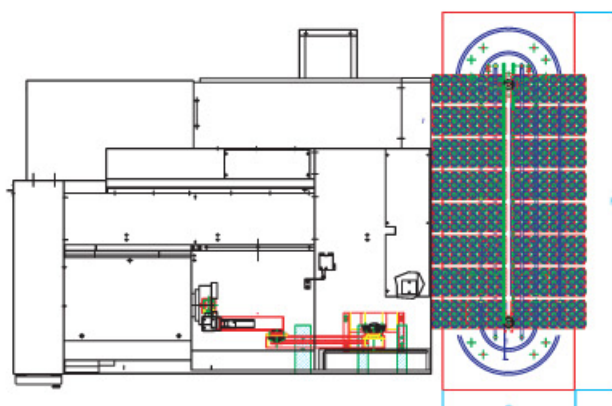

EWR-03 Robot

Product description	1.Three axes robot system use Pendulum swing type design .
	2.Standard three absolute coordinates system, don't need to do reference.
	3.Conversation type robot motion control system, you could specify the robot motion processes via point to point and linear interpolation function.
	4.Easy learning with English language ,easy maintenance with action message ,Key protection function is available and the main operation use hardware buttons, giving us more safety and reliable operation environment.
	5.Linear axis could be added under the robot system to enlarge the working range
	6.The torque detection function could protect the robot mechanism from crash seriously
Function	Parts downloading and uploading for CNC lathe Parts downloading and uploading with A and B faces change of the parts 【Option】
Specification	Coordinates : Rectangular /Cylinder coordinates
	Axis number : 3 axes (J1, J2, J3)
	Installation: Inside the lathe
	Working range:
	J1: 140 degree=20° 160° (100°/sec)
	J2: 359 degree=0° 359° (180°/sec)
	J3: 720 degree=-360° 360° (450°/sec)
	Revolution radius: 850 mm
	Work piece specification:
	Max. Diameter : —φ100mm
	Total loading — 8Kg , work piece net weight could be 3 kg / pc
	Driving way: AC servo motor
	Repeated accuracy : +/- 0.05 mm
	Control ways: The guidance reappears, coordinate value input, operation and edition
	Memory:
	10 operation programs (500 blocks for each program)
	300 guidance positions
	Environment: Temperature: 0~45 C

Inclined pallets type revolution parts loader

This parts loader is suitable for ER-03 robot, general robots and Gantry robots.

Characteristics

- 3-D parts supply, more parts could be stocked
- Parts keep to the side automatically with high repeating accuracy.
- Using different size parts don't need change the pallet within the specified dimensions range; it could reduce lots of cost.
- Without parts stacked could avoid the parts be hurt by crash each other.
- Change pallets or rows easily and quickly • (Change E010308 pallet only need 10sec at most)
- Parts uploading and downloading conforms to the kinesiology.



Equipped with Artistic covers

Parts loader type	Work piece dimensions range	Pallet dimension (W x L)	Pallet weight	Pallet Qty's	Floor area (WxLxH)
WF-E100-08	φ 10 ~120 mm	170 x 400 mm	30kg	08	740 x 1340 x 1300 mm
WF-E100-12	φ 10 ~ 120 mm	170 x 400 mm	30kg	12	740 x 1720 x 1300 mm
WF-E100-16	φ 10 ~ 120 mm	170 x 400 mm	30kg	16	740 x 2100 x 1300 mm

Option:

- Half protection nets for parts loader
- Full protection nets for parts loader

Accessories::

- We have three standard type pallets could be selected ,You could select one type of pallets as the accessory of the parts loader.
- EX.
If you select E010308 pallet as your standard accessory for Parts Loader, we could use it for parts diameter from 10 mm to 46 mm. The parts capacity is 21 pcs. for one pallet.
- We also could make the special pallets according to your requirements.

Standard pallets specifications

Pallet types	Allowed work piece Diameter	Qty's per pallet
E010308	φ10 ~ 46 mm	3x7=21 pcs
E010205	φ40 ~ 74 mm	2x5=10 pcs
E010103	φ70 ~ 120 mm	1x3=3 pcs

Ps : The max. work piece length L=100mm



All specifications are subject to change without prior notice.

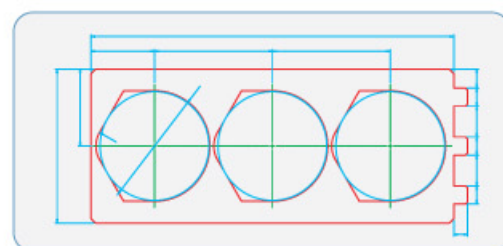
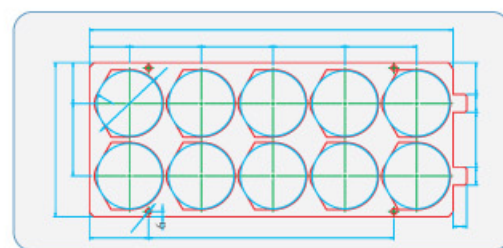
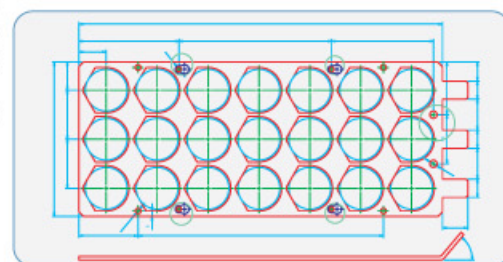

EasyWay Automation Co., Ltd.

No.48, Alley 11, Lane 58, 1st Rd. Industry Park,

Taichung City 407, Taiwan (R.O.C.)

TEL:886-4-23596570 FAX : 886-4-23597276

<http://www.easyway.tw>